

GRAPHIC SCALE

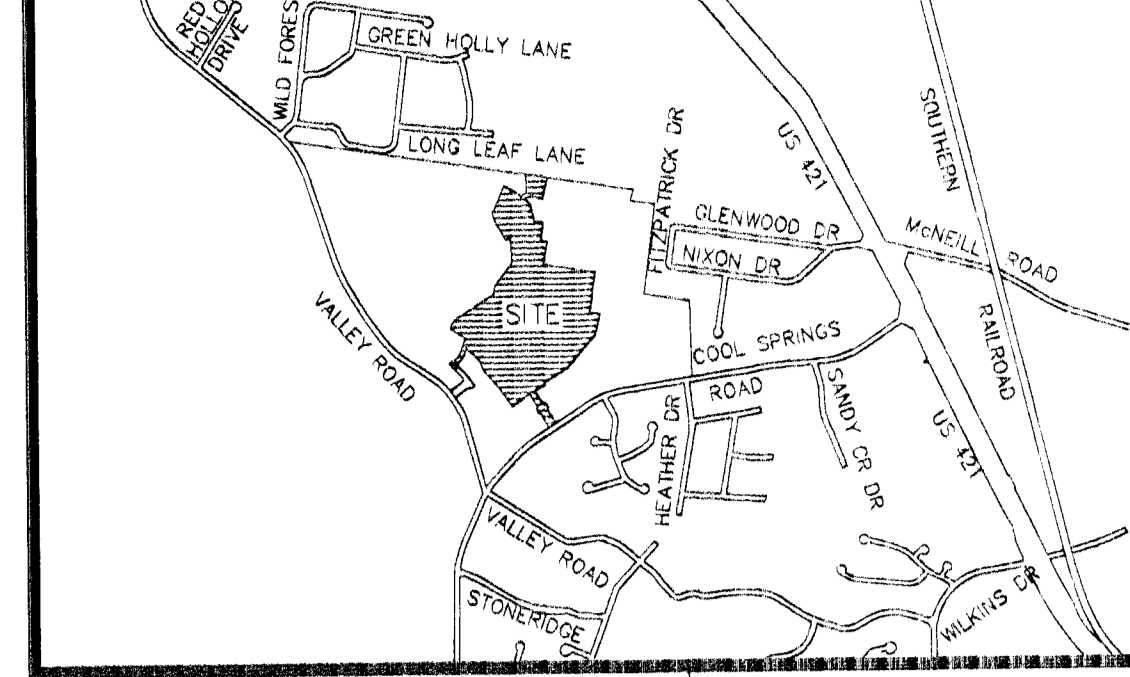

(IN FEET)
1 inch = 100 ft

AREAS
LOTS 100 thru 199 = 38.055 ACRES
LN NEW ROAD R/W = 7.618 ACRES
COMMUNITY AREA = 1.048 ACRES
TOTAL AREA PHASE I = 46.719 ACRES
CALCULATED BY COMPUTER



VICINITY MAP

NOTE: A PORTION OF WESTFALL SUBDIVISION, PHASE I IS LOCATED IN FLOOD ZONE "AE" AS SHOWN ON FLOOD INSURANCE RATE MAP NUMBER: 37109834000, OF LEE COUNTY, NC EFFECTIVE DATE: SEPT. 8, 2008.

NOTE: PLAT CABINET 2007, SLIDE 181 15' SANITARY SEWER EASEMENT 7.5' EITHER SIDE OF SEWER LINE (TYPICAL)

REMAINING PORTION OF ALBERT C. ADCOCK DB 683, P. 112 PC 4, SLIDE 193

ALBERT C. ADCOCK DB 954, P. 839 PC 4, SLIDE 193

LEGEND
CL - CENTERLINE
ECM - EXISTING CONCRETE MONUMENT
ERS - EXISTING RAILROAD SPIKE
EIS - EXISTING SOLID IRON
ES - SOLID IRON SET
ESRS - SET RAILROAD SPIKE
ESD - TOTAL DISTANCE
R/W - RIGHT OF WAY
E - EXISTING MAN HOLE
S - SOLID IRON SET
* LOTS - ARE APPROXIMATE AREAS OF FLOOD ZONE AND BUILDABLE AREA

*LOTS 111-113, 125-143

Table with columns: LOT, FLOOD ZONE AREA, BUILDABLE AREA. Lists lots 111 through 143 with their respective areas.

ALL FLOOD ZONE AREAS AND BUILDABLE AREAS ARE APPROXIMATE AND ARE INTERPOLATED FROM FLOOD INSURANCE RATE MAP NUMBER 37109834000

NOTE: A 15' SANITARY SEWER EASEMENT ALONG THE REAR OF LOT 109 (AS SHOWN) FOR LOT 110 AND THE COMMUNITY AREA.

REMAINING PORTION OF ALBERT C. ADCOCK DB 683, P. 112 PC 4, SLIDE 193

ALBERT C. ADCOCK DB 954, P. 839 PC 4, SLIDE 193

REMAINING PORTION OF ALBERT C. ADCOCK DB 683, P. 112 PC 4, SLIDE 193

ALBERT C. ADCOCK DB 954, P. 839 PC 4, SLIDE 193

REMAINING PORTION OF ALBERT C. ADCOCK DB 683, P. 112 PC 4, SLIDE 193

ALBERT C. ADCOCK DB 954, P. 839 PC 4, SLIDE 193

REMAINING PORTION OF ALBERT C. ADCOCK DB 683, P. 112 PC 4, SLIDE 193

ALBERT C. ADCOCK DB 954, P. 839 PC 4, SLIDE 193

REMAINING PORTION OF ALBERT C. ADCOCK DB 683, P. 112 PC 4, SLIDE 193

ALBERT C. ADCOCK DB 954, P. 839 PC 4, SLIDE 193

REMAINING PORTION OF ALBERT C. ADCOCK DB 683, P. 112 PC 4, SLIDE 193

ALBERT C. ADCOCK DB 954, P. 839 PC 4, SLIDE 193

REMAINING PORTION OF ALBERT C. ADCOCK DB 683, P. 112 PC 4, SLIDE 193

ALBERT C. ADCOCK DB 954, P. 839 PC 4, SLIDE 193

REMAINING PORTION OF ALBERT C. ADCOCK DB 683, P. 112 PC 4, SLIDE 193

ALBERT C. ADCOCK DB 954, P. 839 PC 4, SLIDE 193

REMAINING PORTION OF ALBERT C. ADCOCK DB 683, P. 112 PC 4, SLIDE 193

ALBERT C. ADCOCK DB 954, P. 839 PC 4, SLIDE 193

REMAINING PORTION OF ALBERT C. ADCOCK DB 683, P. 112 PC 4, SLIDE 193

ALBERT C. ADCOCK DB 954, P. 839 PC 4, SLIDE 193

REMAINING PORTION OF ALBERT C. ADCOCK DB 683, P. 112 PC 4, SLIDE 193

ALBERT C. ADCOCK DB 954, P. 839 PC 4, SLIDE 193

NOTE: REVISION 01-27-2015 CHANGE NAME OF SUBDIVISION TO "AUTUMNWOOD" ADDED CURRENT OWNERS NAMES, ADDRESSES AND DEED REFERENCES.

Subdivision Survey Form for AUTUMNWOOD SUBDIVISION PHASE I. Includes fields for Township (West Sanford), County (Lee), State (North Carolina), Date Completed (05-05-2010), and other survey details.

Table with columns: LINE, DIRECTION, DISTANCE, RADIUS, LENGTH. Lists survey data for lines 1 through 114.

Table with columns: LINE, DIRECTION, DISTANCE, RADIUS, LENGTH. Lists survey data for lines 115 through 199.

Table with columns: LINE, DIRECTION, DISTANCE, RADIUS, LENGTH. Lists survey data for lines 200 through 299.

REFERENCE: WESTFALL SUBDIVISION, PHASE I PC 2010, SLIDE 64 LOTS 104, 113, 129, 131, 138, 139 AND 139.9

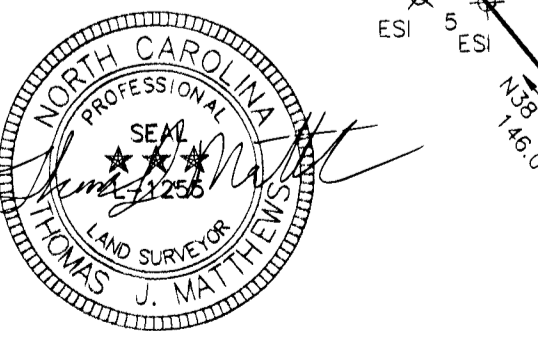

STATE OF NORTH CAROLINA
COUNTY OF LEE
PLAT NO. 2015-160
DATE: 1/27/2015

OWNER: ALBERT C. ADCOCK AND WIFE DOROTHY R. ADCOCK 2164 VALLEY ROAD SANFORD, NC 27330

OWNER: DONALD T. OLDAH AND WIFE SUSAN R. OLDAH 2413 BROOKWOOD TRAIL SANFORD, NC 27330

OWNER: REK BROWN 7301 VILLANOW DRIVE SANFORD, NC 27330

OWNER: WESTFALL SANFORD, LLC PO BOX 37 SANFORD, NC 27331

OWNER: PRESERVATION HOMES OF SANFORD, LLC DB 1369, P. 460 WESTFALL SUBDIVISION, PHASE 1 PC 2010, SLIDE 64 LOT 103

OWNER: PRESERVATION HOMES OF SANFORD, LLC DB 1369, P. 458 WESTFALL SUBDIVISION, PHASE 1 PC 2010, SLIDE 64 LOTS 100, 101, 102